

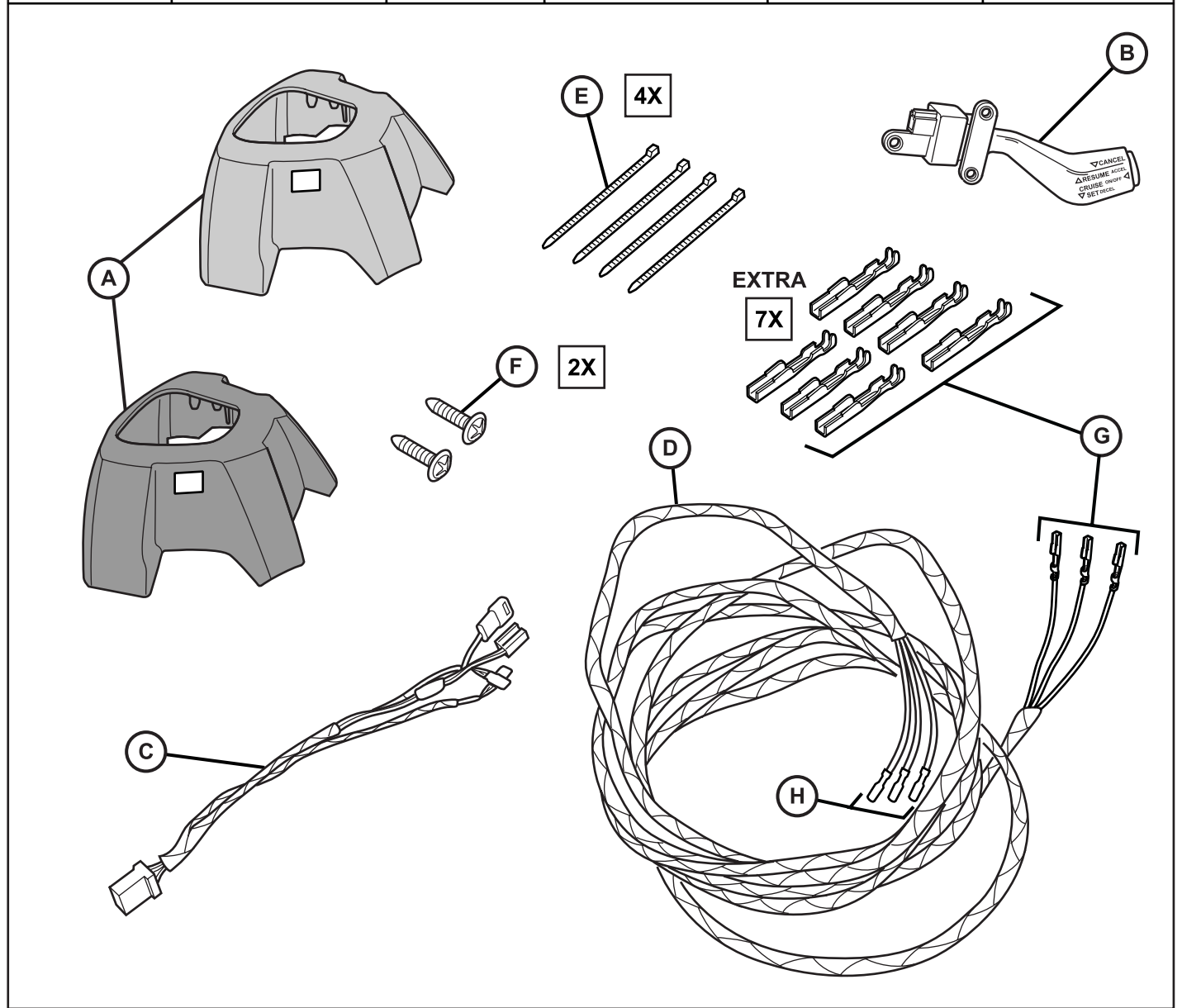

JEEP PATRIOT

Speed Control Kit

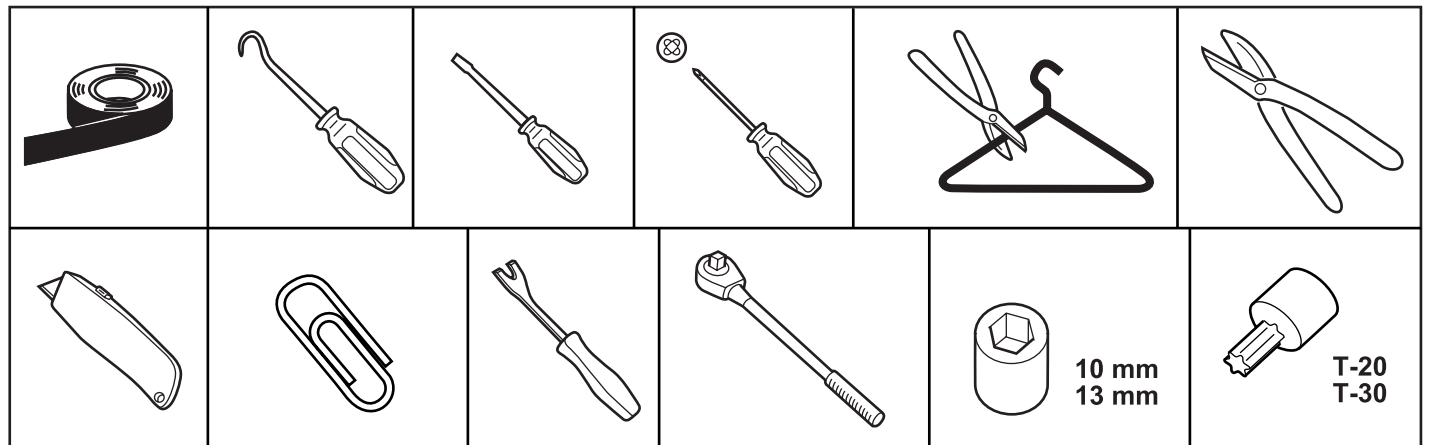



SOME VEHICLES MAY BE PRE-WIRED. CHECK VEHICLE SPEED CONTROL CIRCUITS SHOWN BELOW FOR CONTINUITY. IF CONTINUITY EXISTS IN ALL CIRCUITS BETWEEN PCM AND SCM, SKIP TO STEP 20. OTHERWISE, PROCEED AS FOLLOWS.



CERTAINS VÉHICULES DOIVENT ÊTRE PRÉCÂBLÉS. VÉRIFIER LES CIRCUITS DE RÉGLAGE DE LA VITESSE ILLUSTRÉS CI-DESSOUS POUR LA CONTINUITÉ. SI LA CONTINUITÉ EST PRÉSENTE DANS TOUS LES CIRCUITS ENTRE LE PCM ET LE SCM, PASSER À L'ÉTAPE 20. SINON, PROCÉDER COMME CECI.



ALGUNOS VEHÍCULOS PUEDEN TENER LA PREPARACIÓN DEL CABLEADO. COMPRUEBE LA CONTINUIDAD DE LOS CIRCUITOS DE CONTROL DE VELOCIDAD DEL VEHÍCULO QUE SE MUESTRAN A CONTINUACIÓN. SI HAY CONTINUIDAD EN TODOS LOS CIRCUITOS, ENTRE EL PCM Y EL SCM, CONTÍNE EN EL PASO 20. DE LO CONTRARIO, PROCEDA A HACER LO SIGUIENTE.

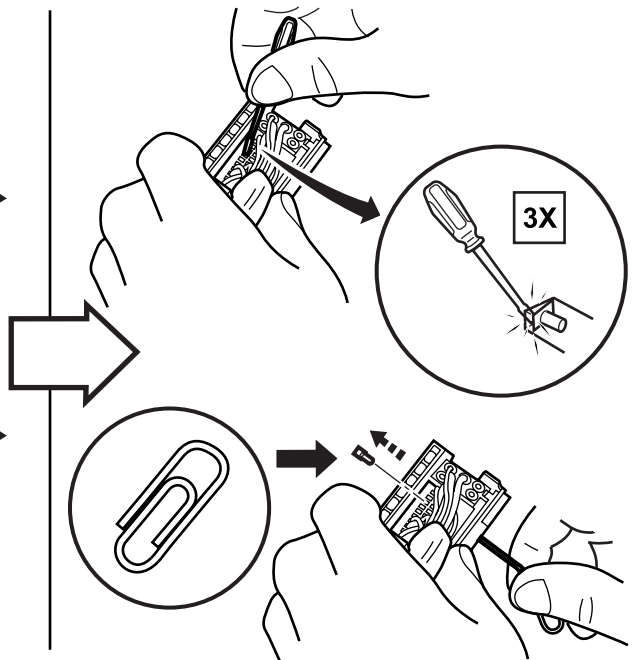
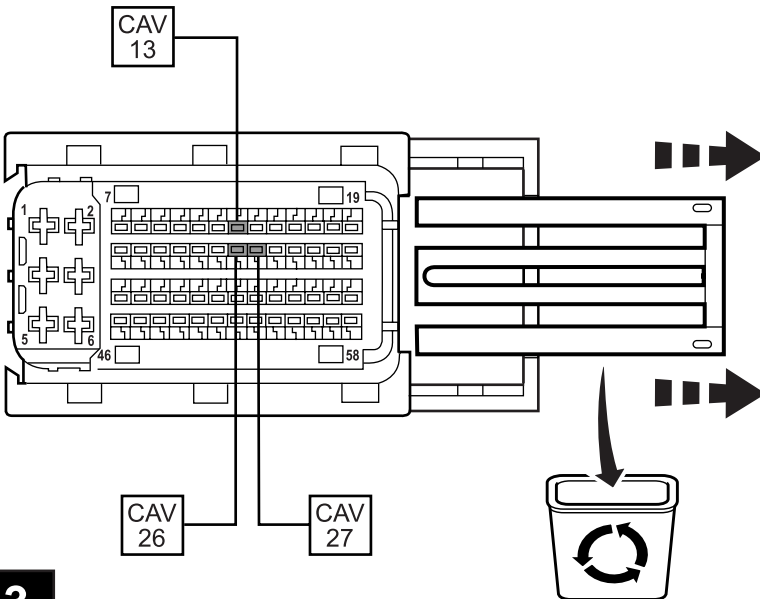
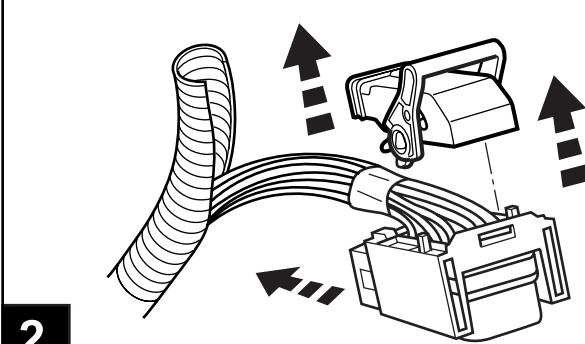
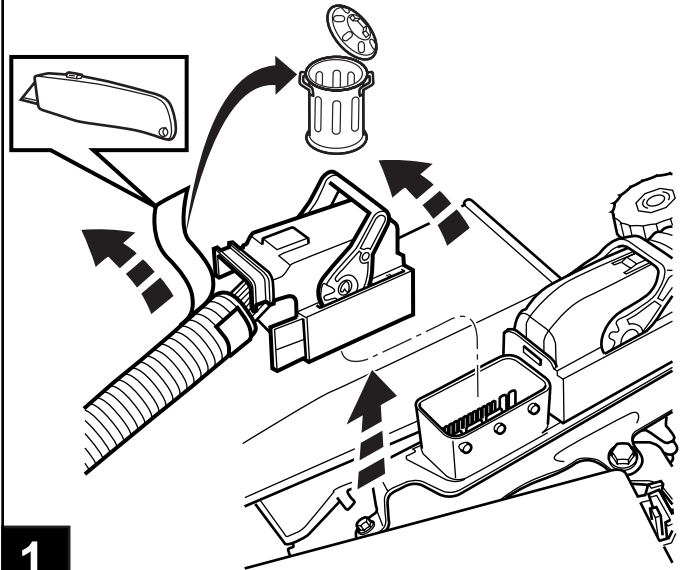
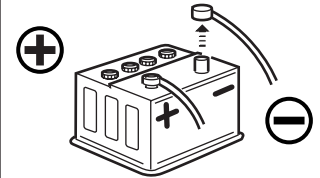
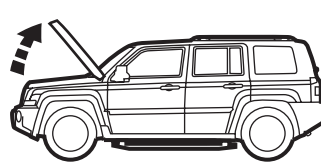
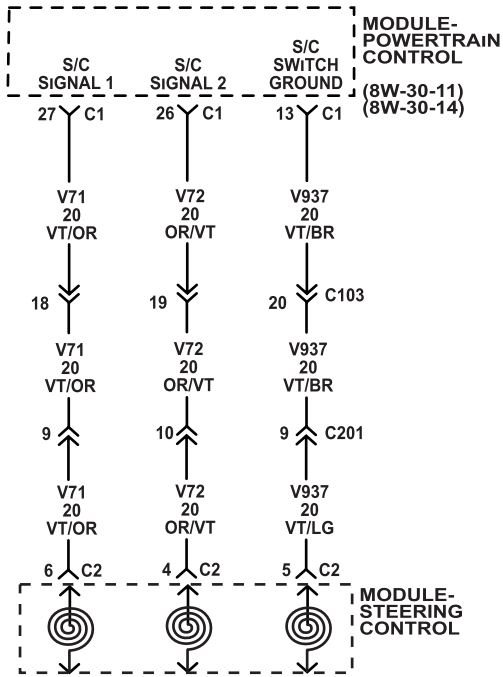

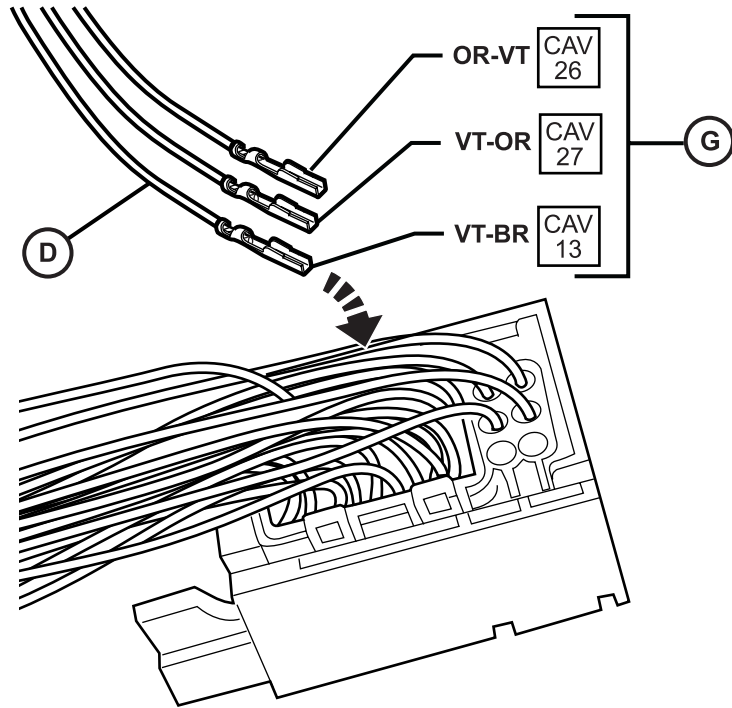

4

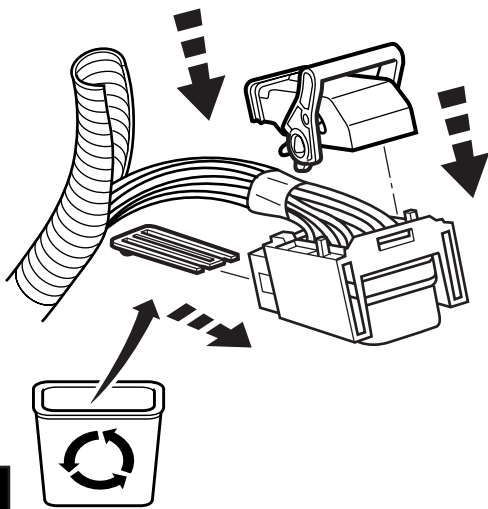

5

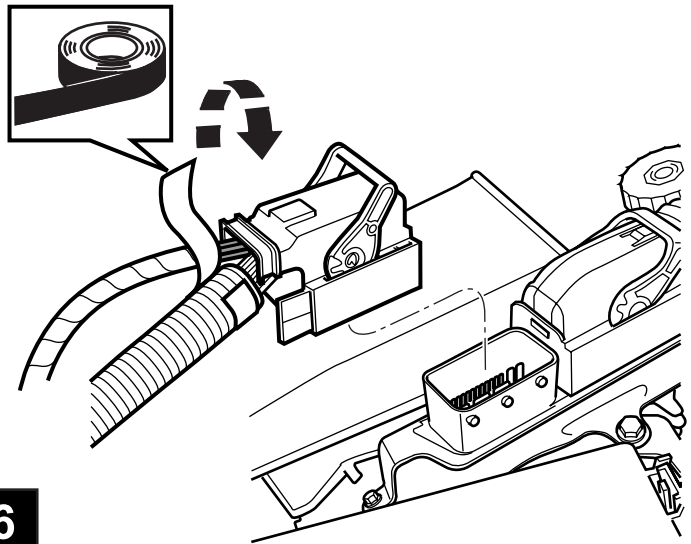

6

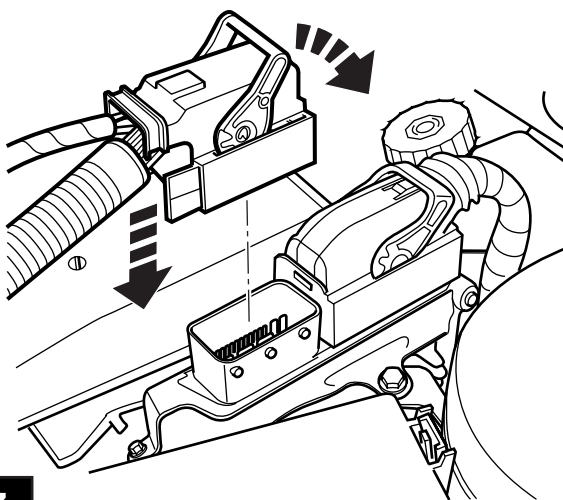

7

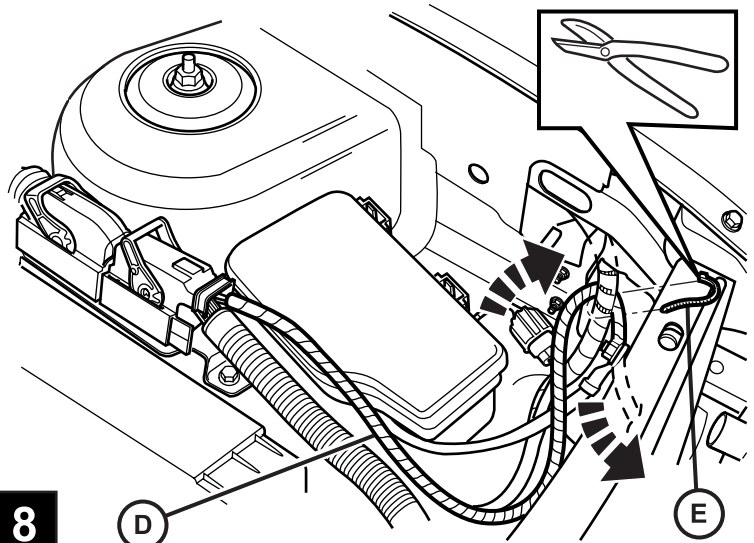

8

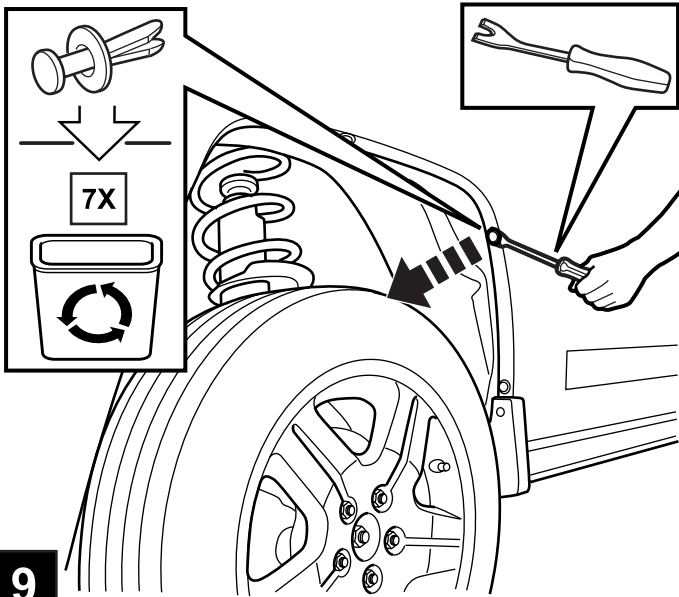

9

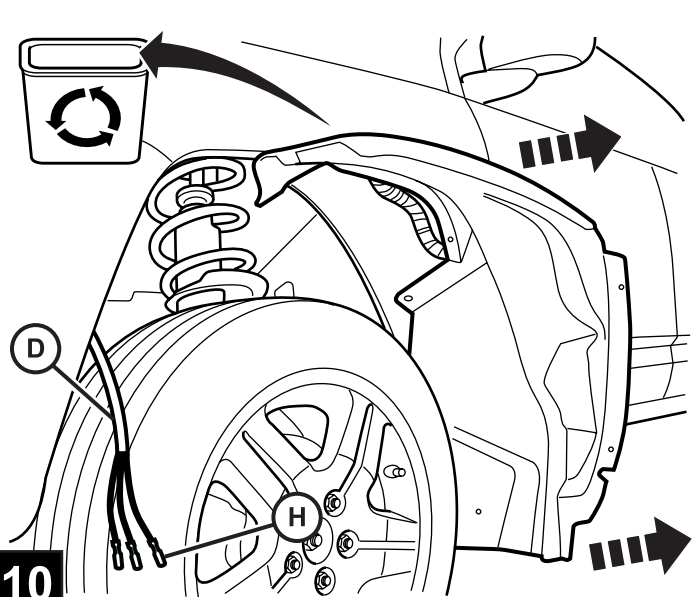

10

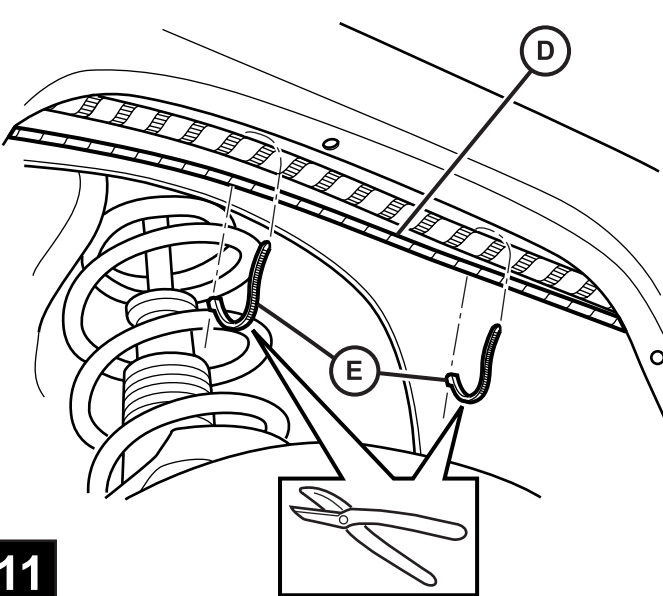

11

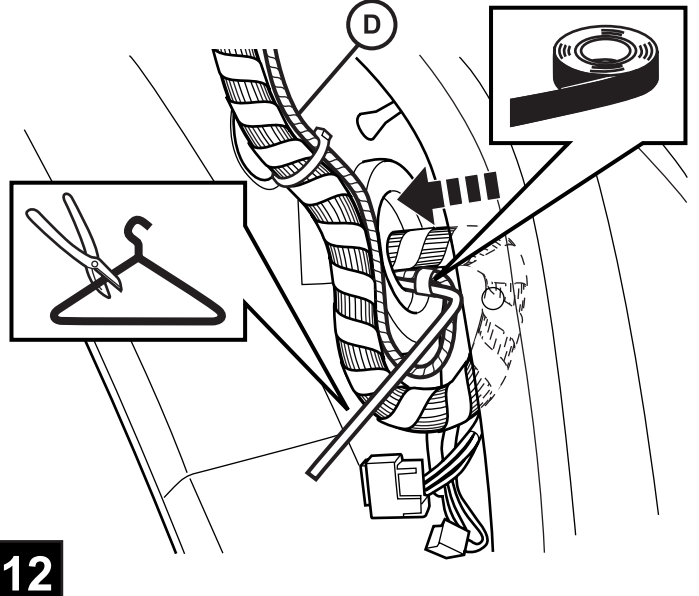

12

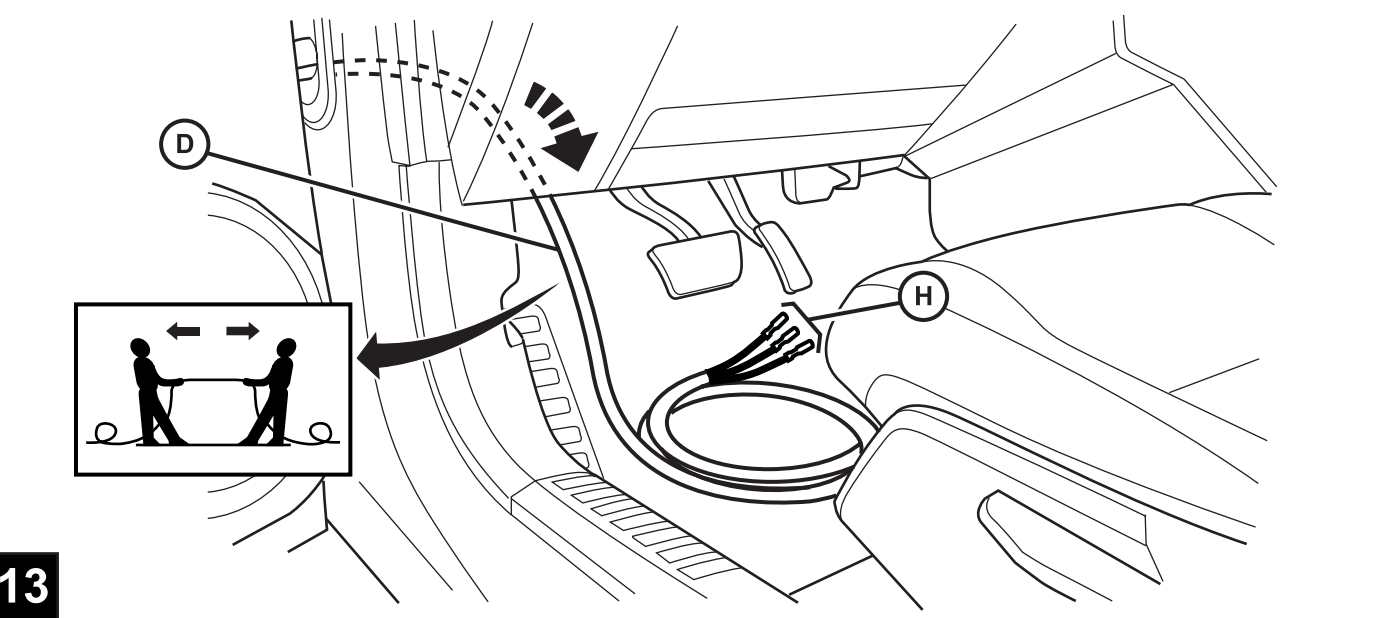

13

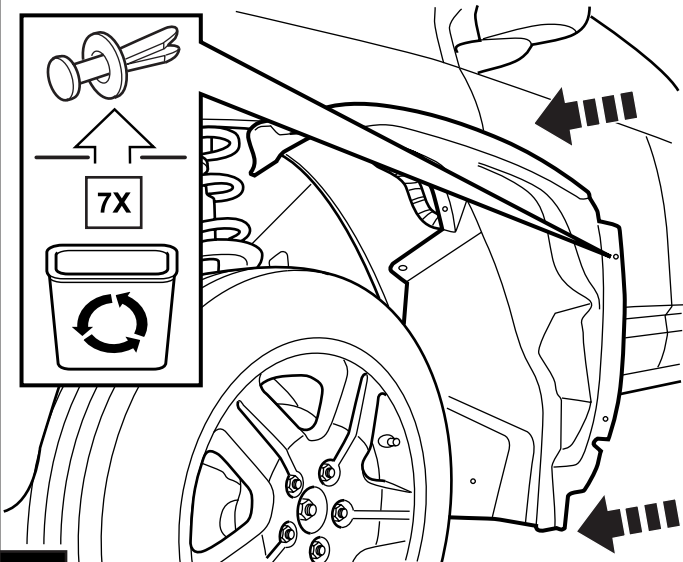

14

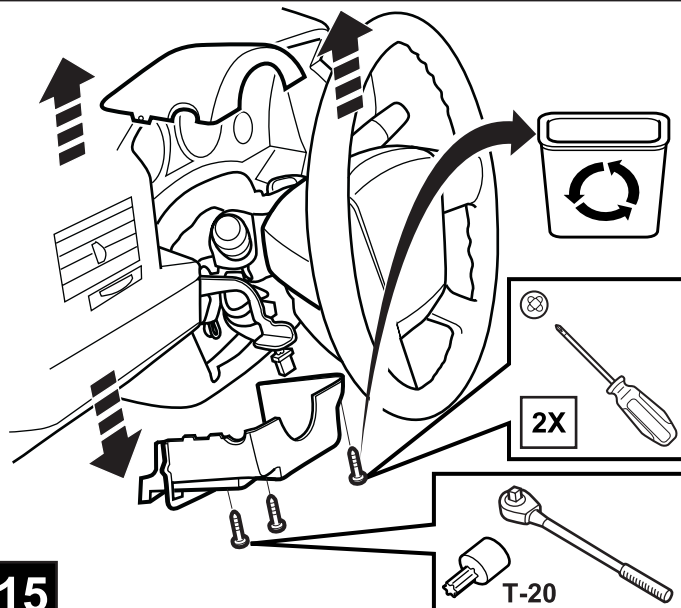

15

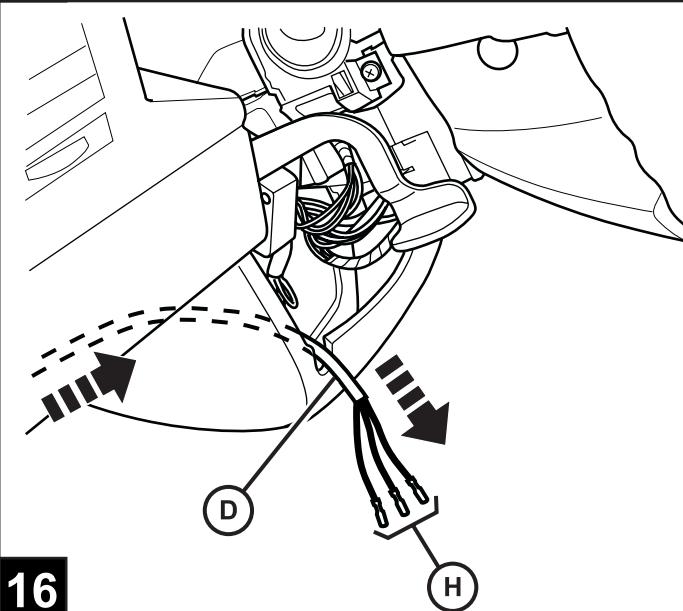

16

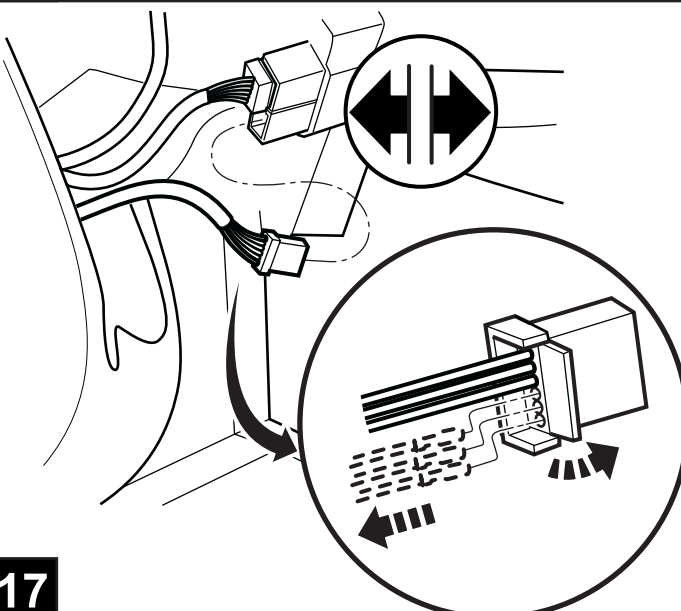

17

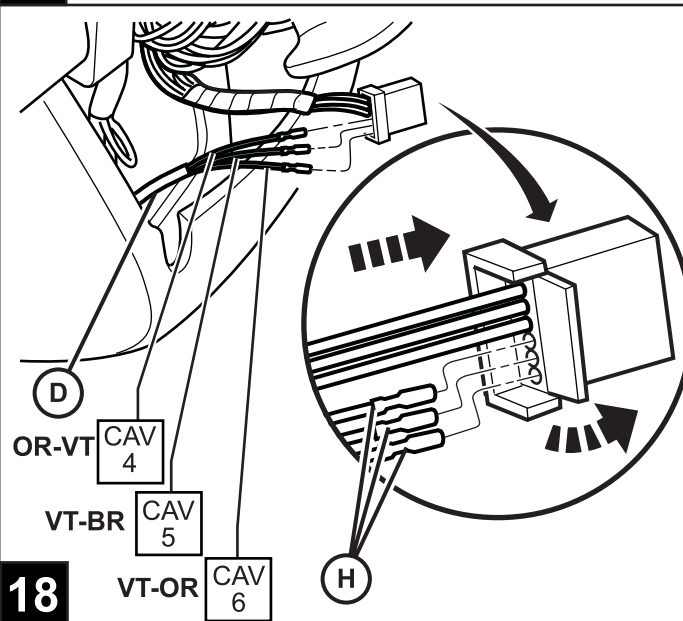

18

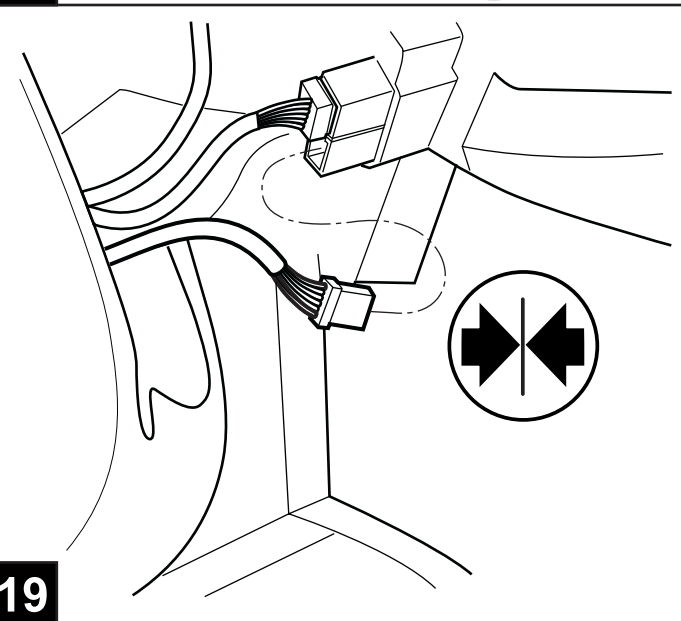

19

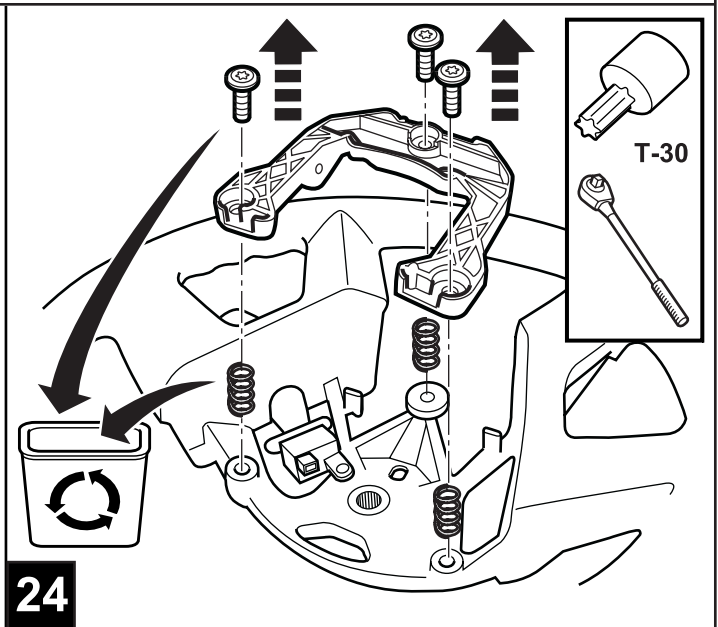
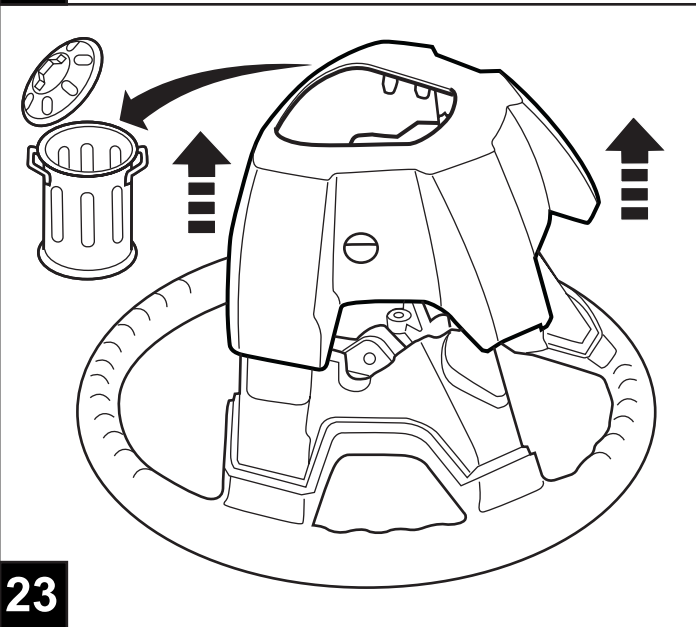
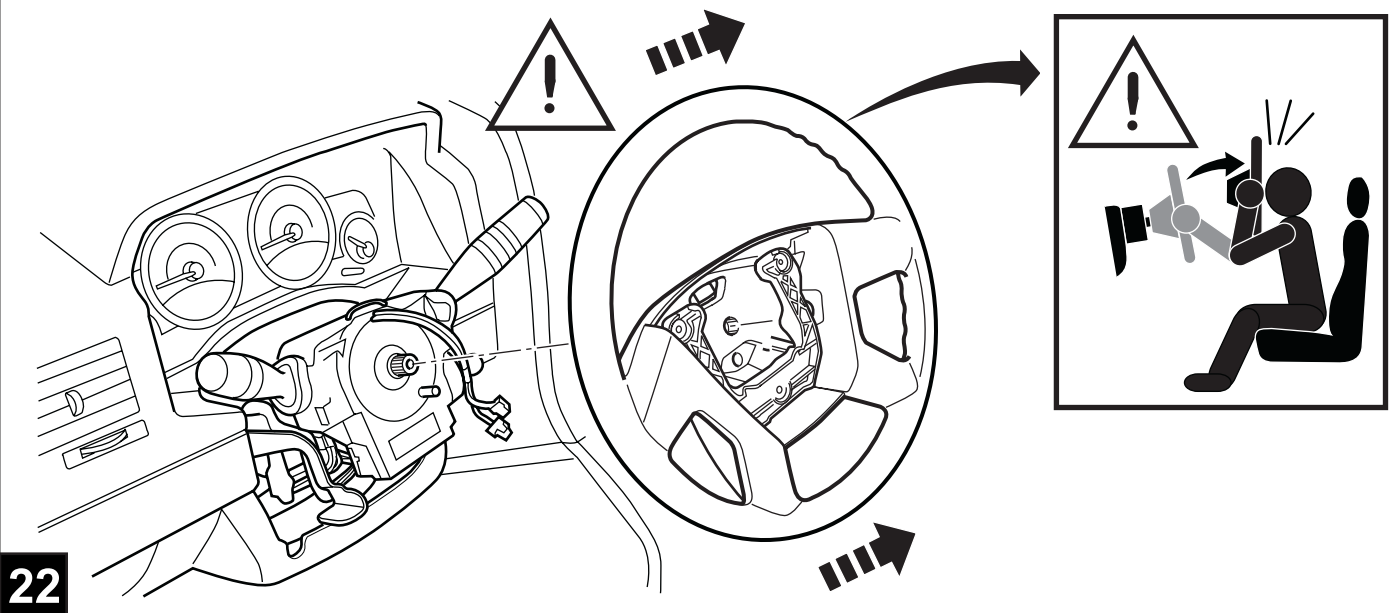
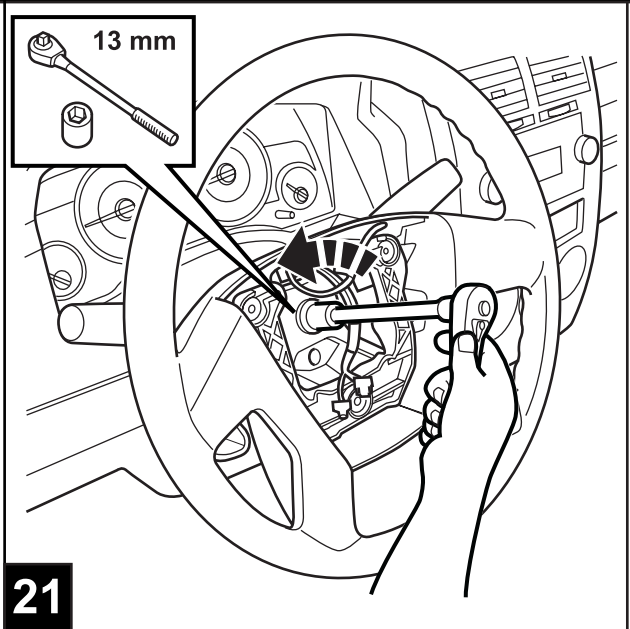
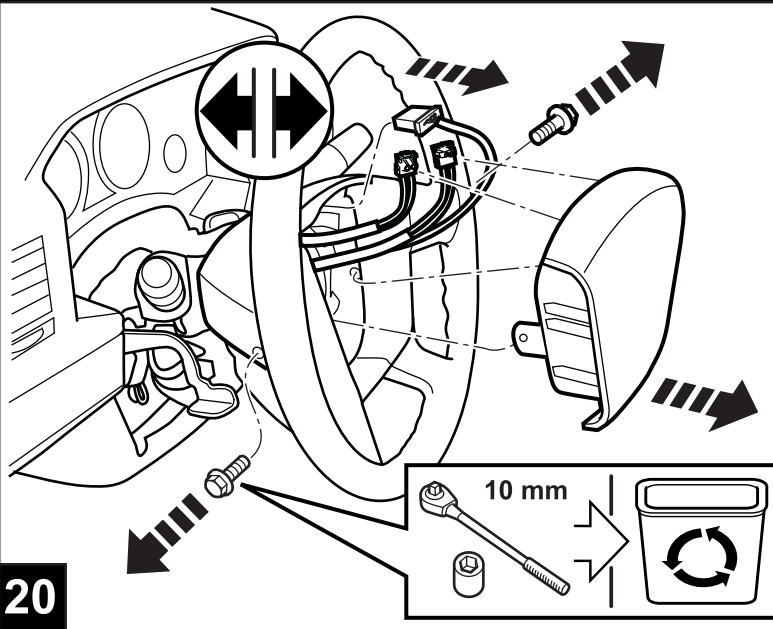

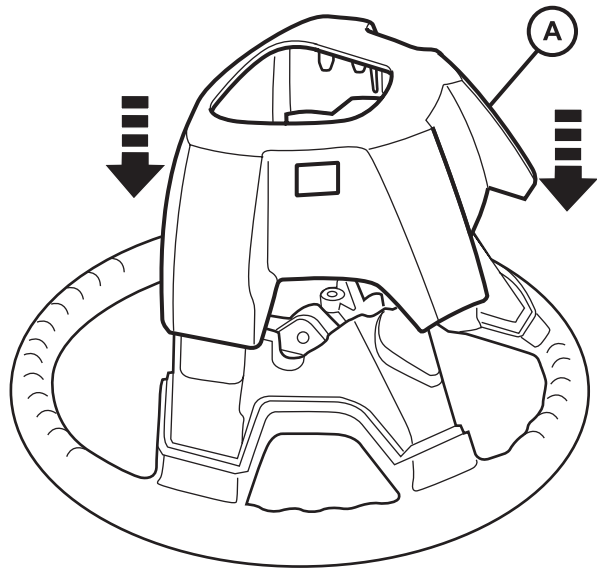

25

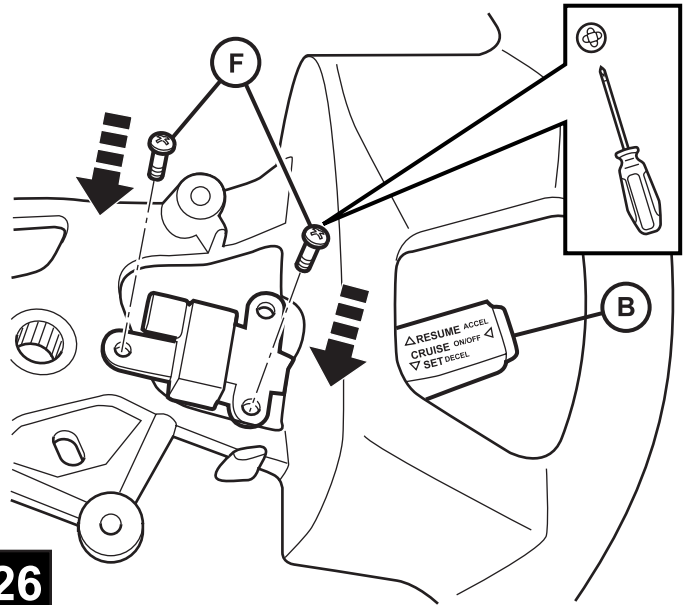

26

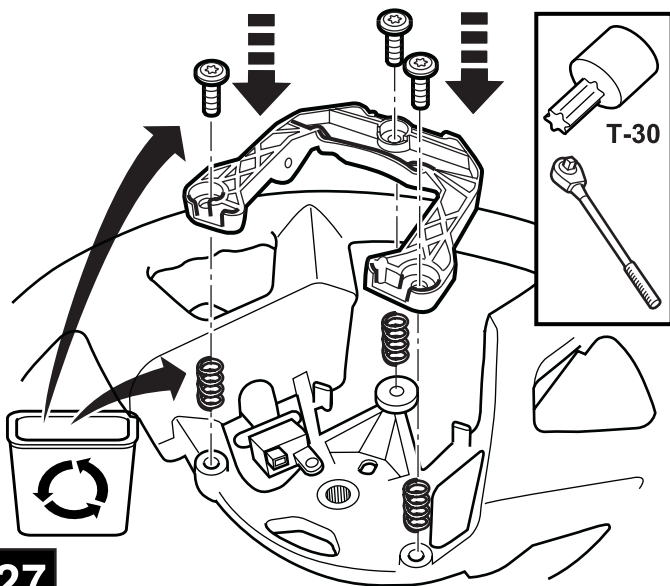

27

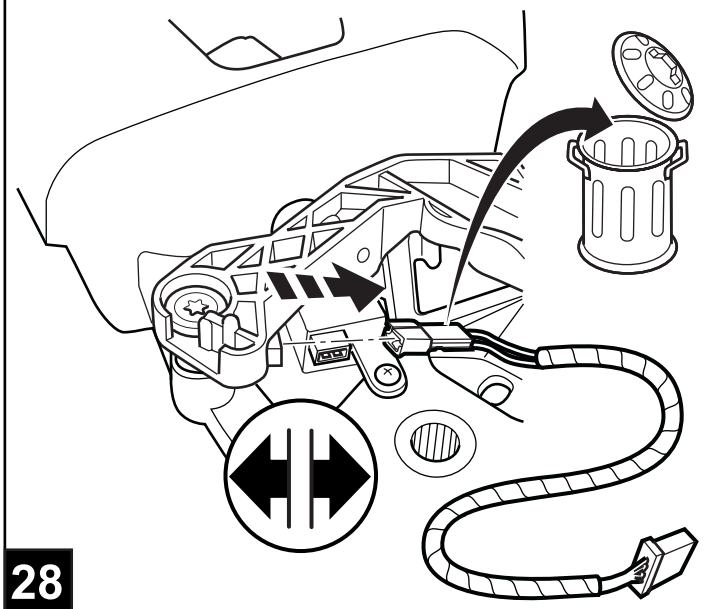

28

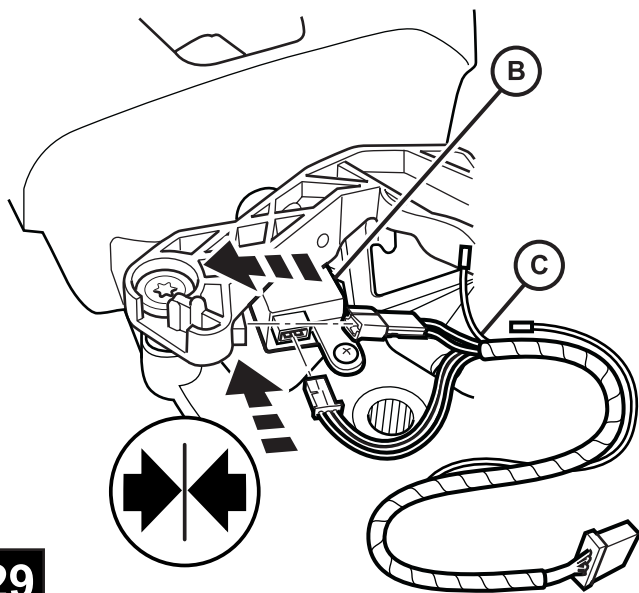

29

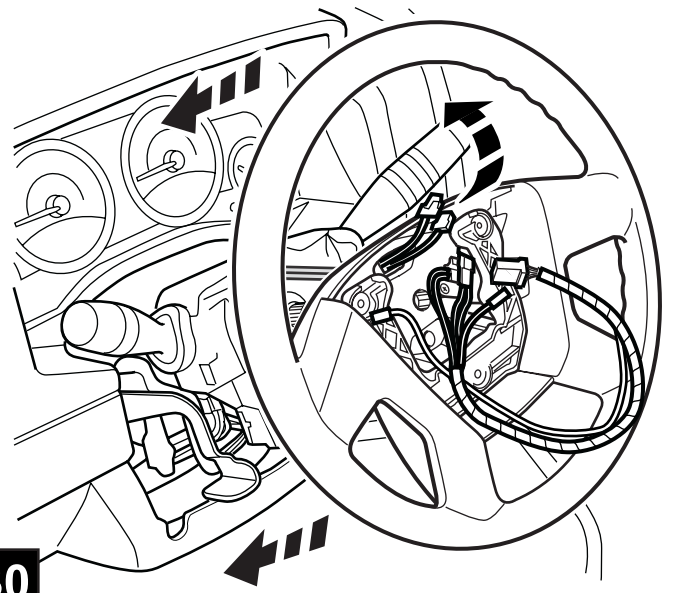

30

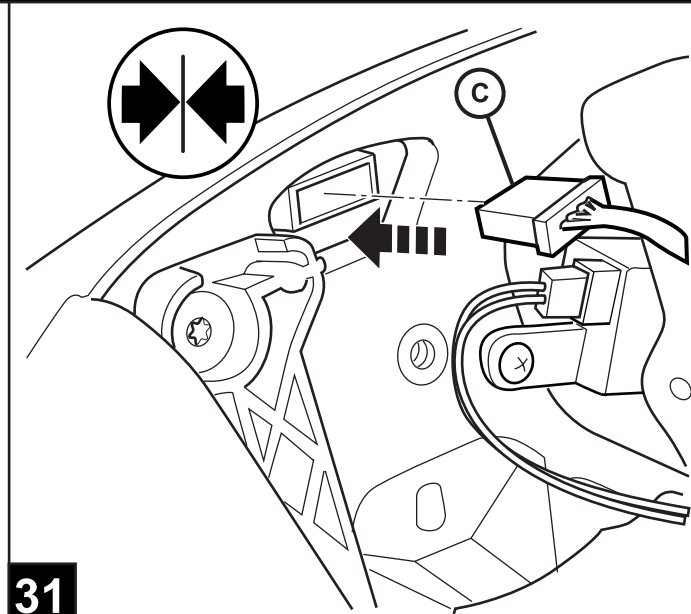

31

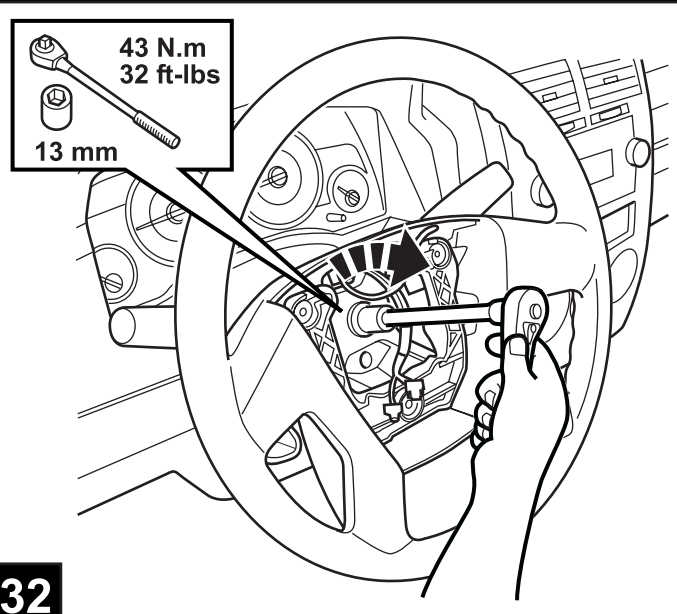

32

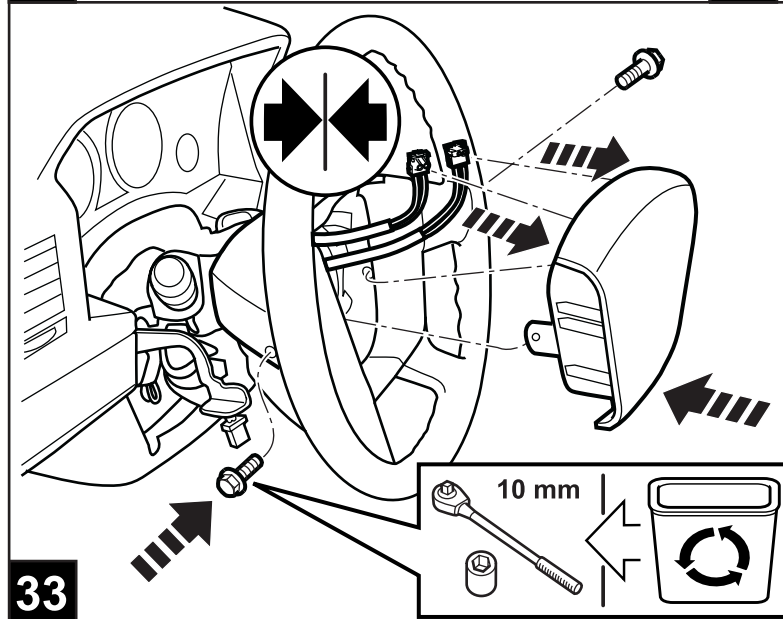

33

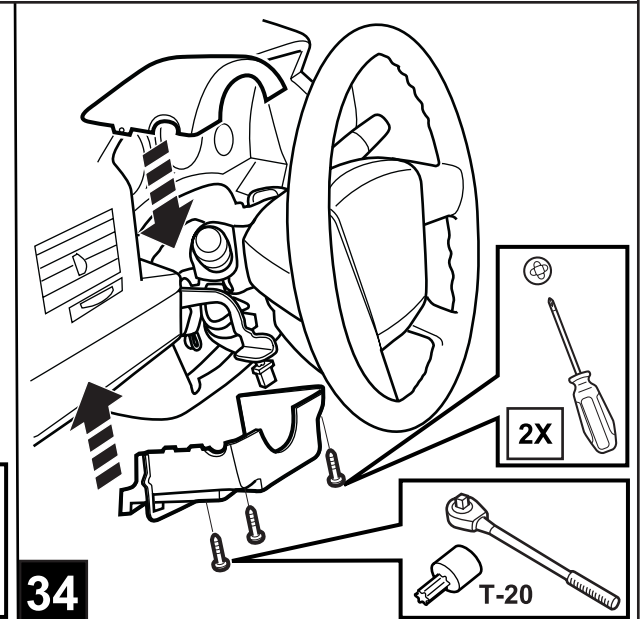

34

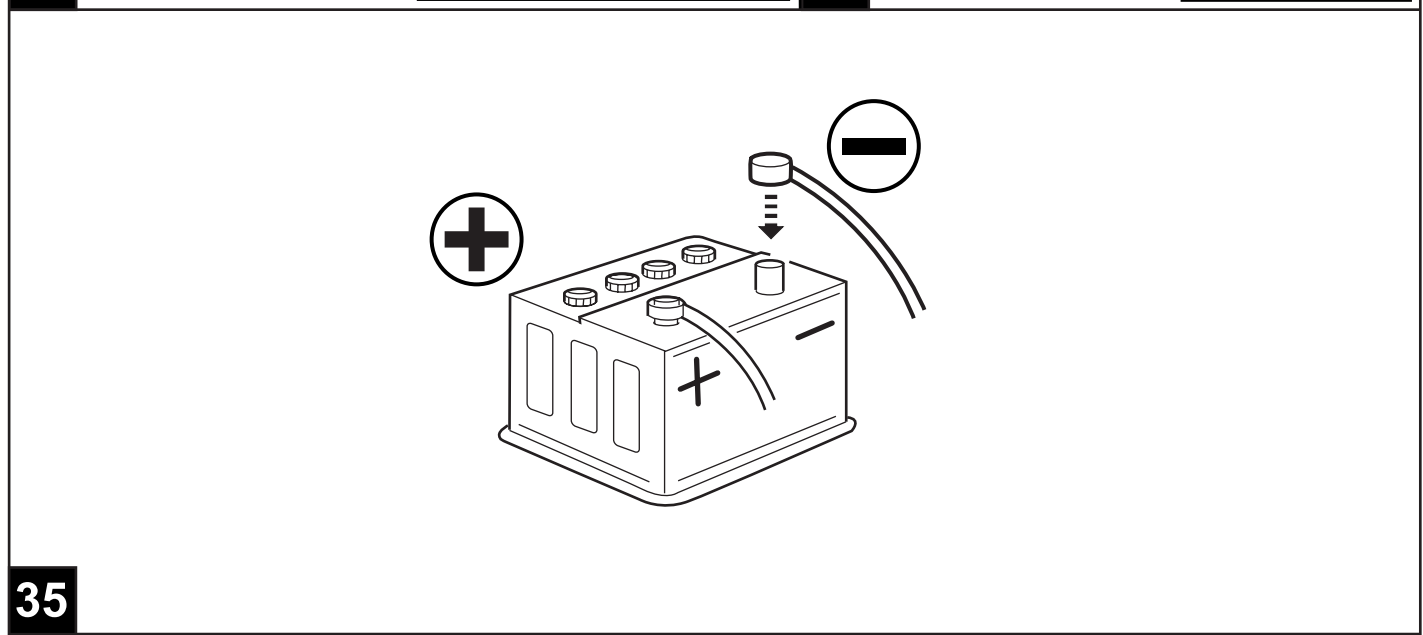

35

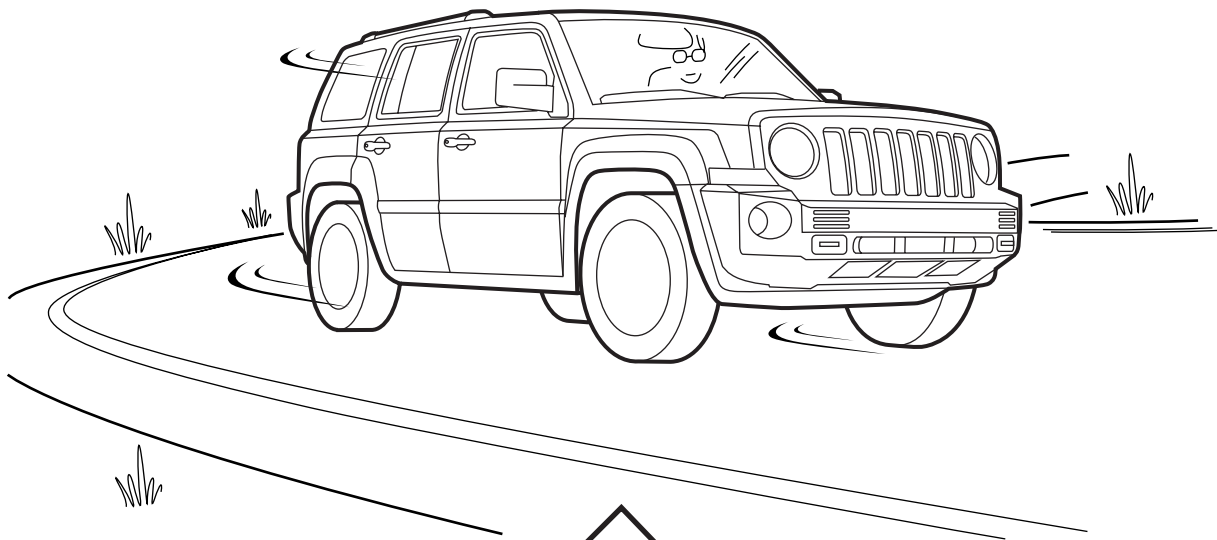

36

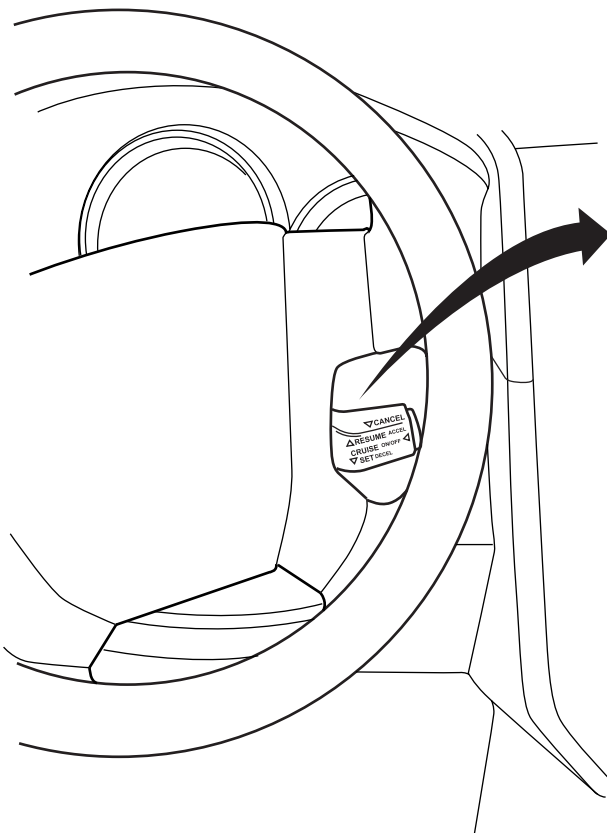

			<input checked="" type="checkbox"/>
			<input checked="" type="checkbox"/>
			<input checked="" type="checkbox"/>
			<input checked="" type="checkbox"/>

37