

Read entire instructions thoroughly before starting.

TOOLS REQUIRED

- Phillips screwdriver
- Center punch
- Felt tip Marker
- Drill stop
- Drill bit (5/16", 8mm)
- Masking tape
- Tape Measure
- Drill

CONTENTS:

No.	Qty.	Description
①	1	Rear Air Deflector
②	1	Mounting Template
③	4	Pan Head Screws
④	4	Countersink Screws
⑤	4	Well Nuts
⑥	2	Stanchions
⑦	2	Foam Pads (Top)
⑧	2	Foam Pads (Bottom)
⑨	4	Nylon Profile Washers

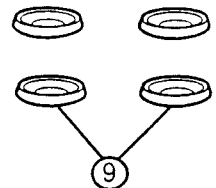
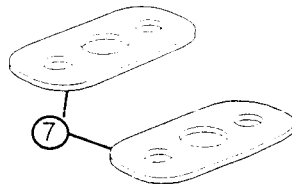
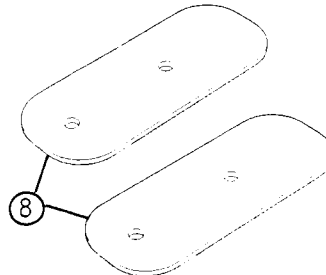
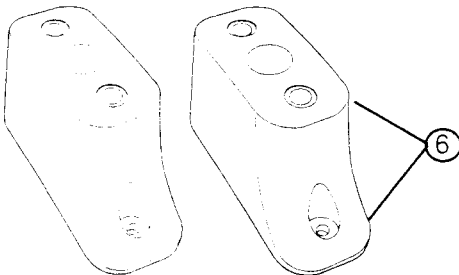
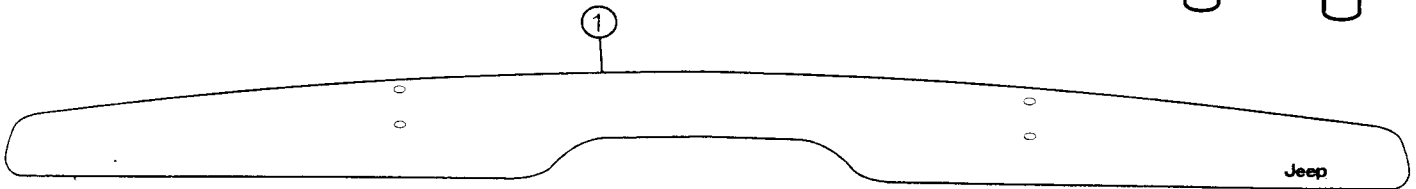
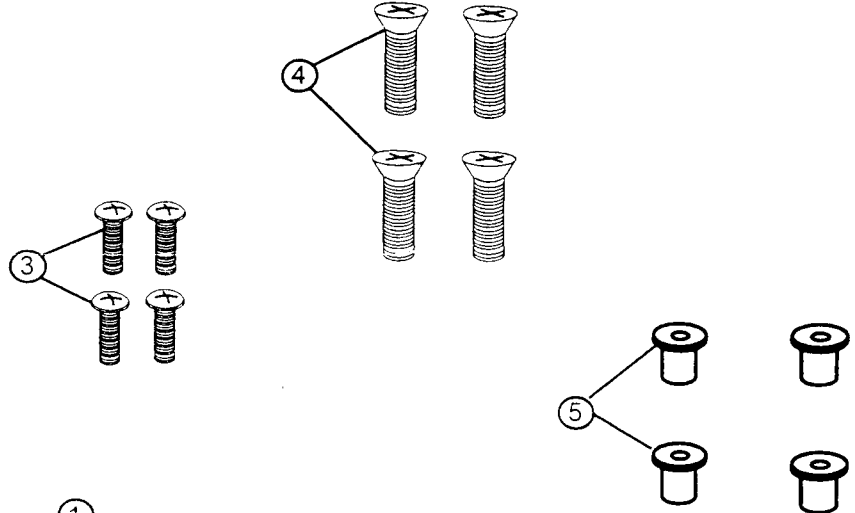

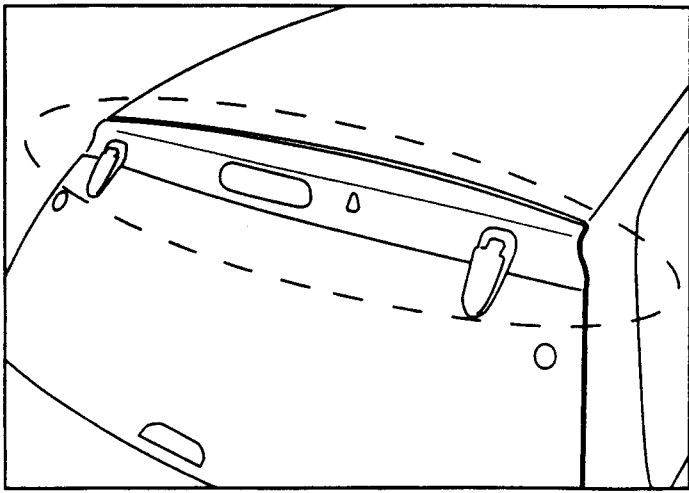

1) Wash the top of the rear liftgate, rinse and dry thoroughly.

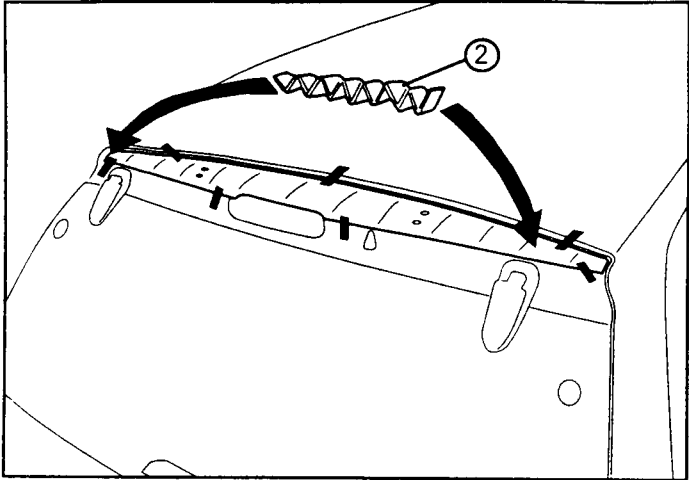

2) Align the paper template with the top edge of the rear door and tape.

NOTE:

BE SURE TO POSITION THE TEMPLATE CORRECTLY AROUND THE THIRD BRAKELIGHT.

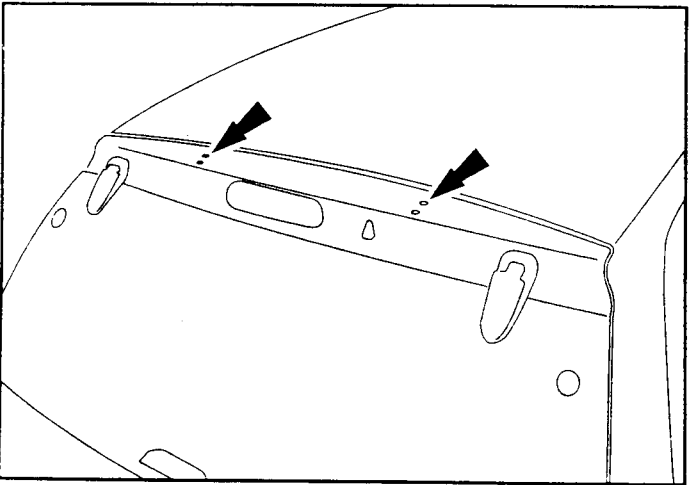

3) Using a center punch mark the center of the four holes. Remove the template. Then drill four 5/16" holes into the door.

CAUTION:

BE CAREFUL TO DRILL THROUGH THE OUTER DOOR SKIN ONLY.

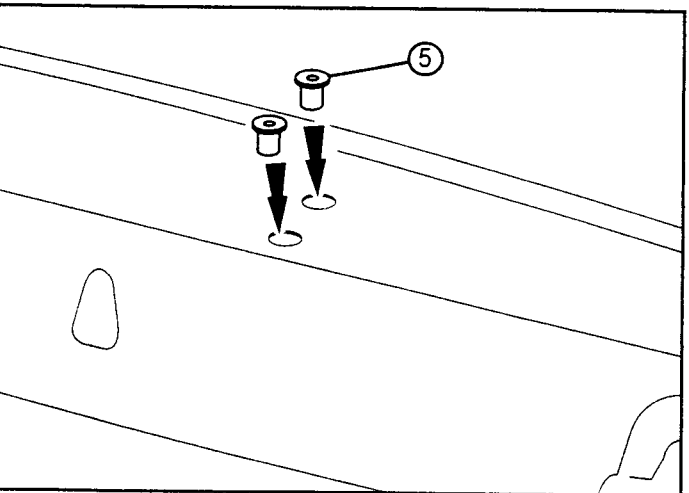

4) Place the four well nuts in to the four holes.

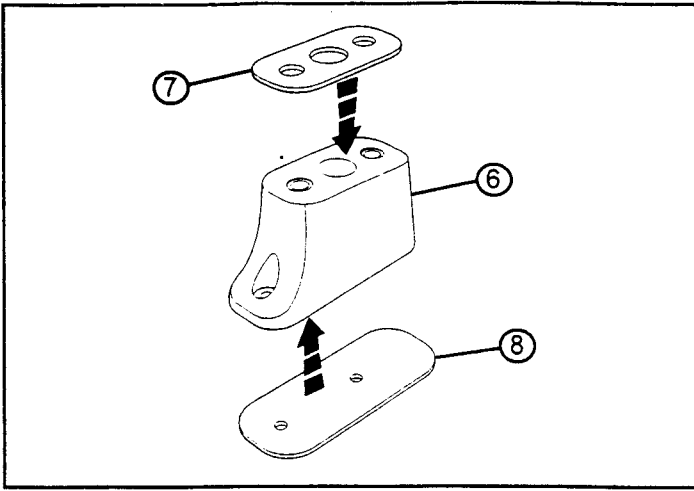

5) Adhere the two foam pads to the top and bottom of both stanchions as shown.

NOTE:

BE SURE TO POSITION THE PADS CORRECTLY AROUND THE STANCHION EDGES AND HOLES.

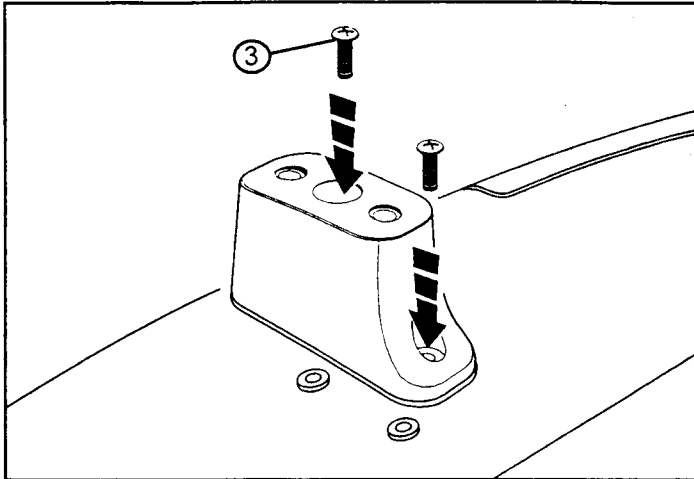

6) Mount the stanchions to the rear door using the four pan head machine screws as shown.

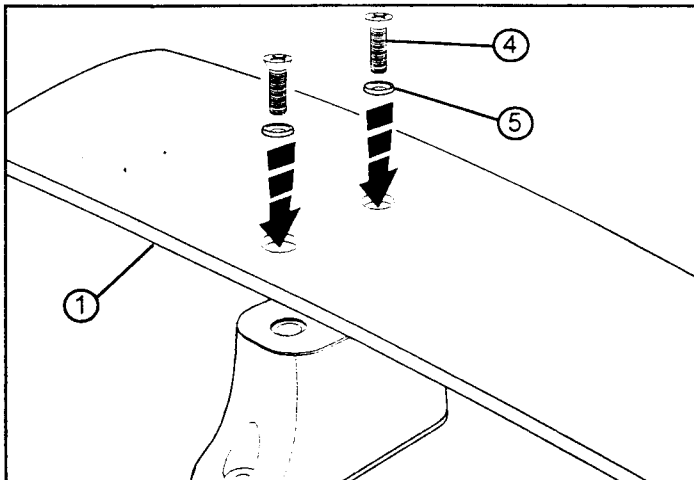

7) Mount the deflector to the stanchions using the four countersunk screws and four nylon washers as shown.

CAUTION:

DO NOT USE A POWER DRILL. BE SURE TO HAND TIGHTEN ONLY.

CARE AND CLEANING:

1. To clean use hot water and a mild soap.
2. **DO NOT USE** any types of solvents, it will destroy the surface of your deflector.
3. **CAUTION**, avoid the use of "Brush" style car washes.