

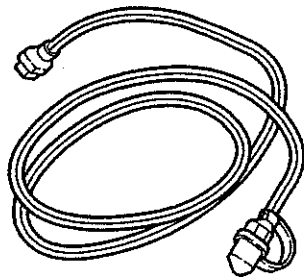

MOPAR.

2.4 L ENGINE BLOCK HEATER

Engine Block Heater
Réchauffeur de bloc de moteur



A

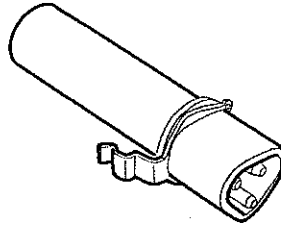

B

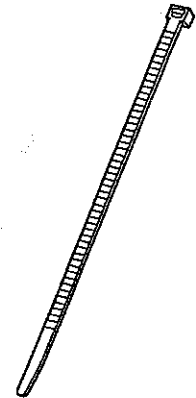

C 4x

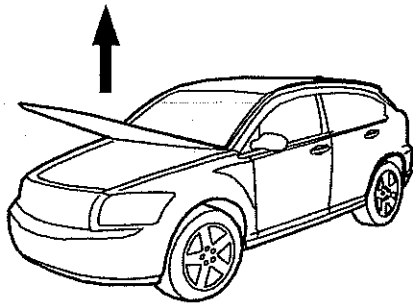

1

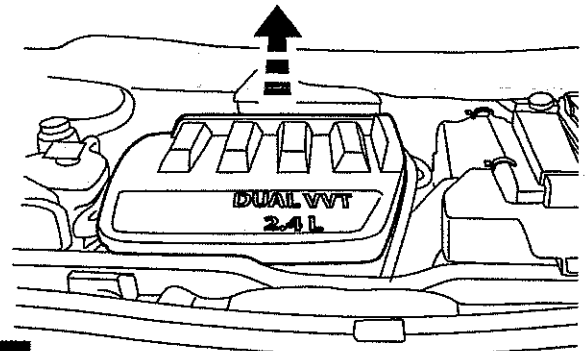

2

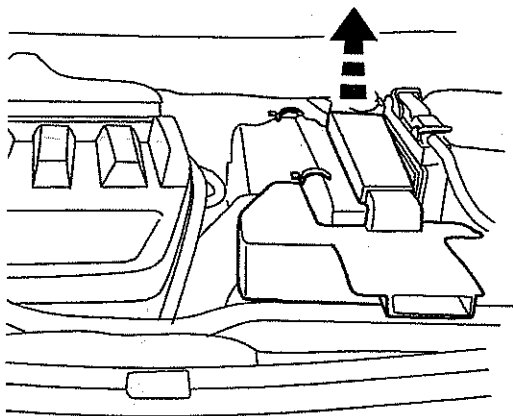

3

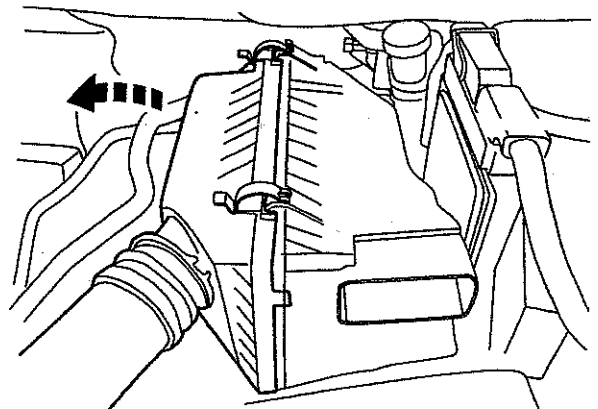

4

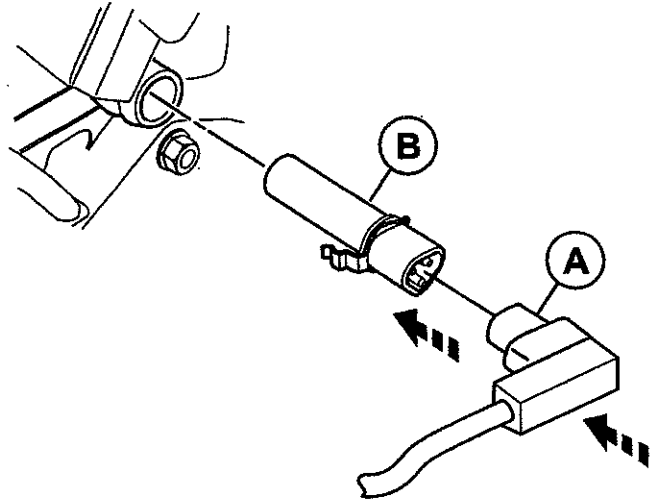
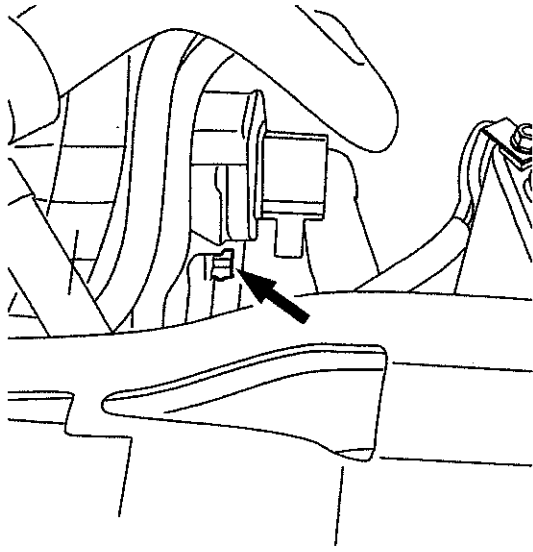

5

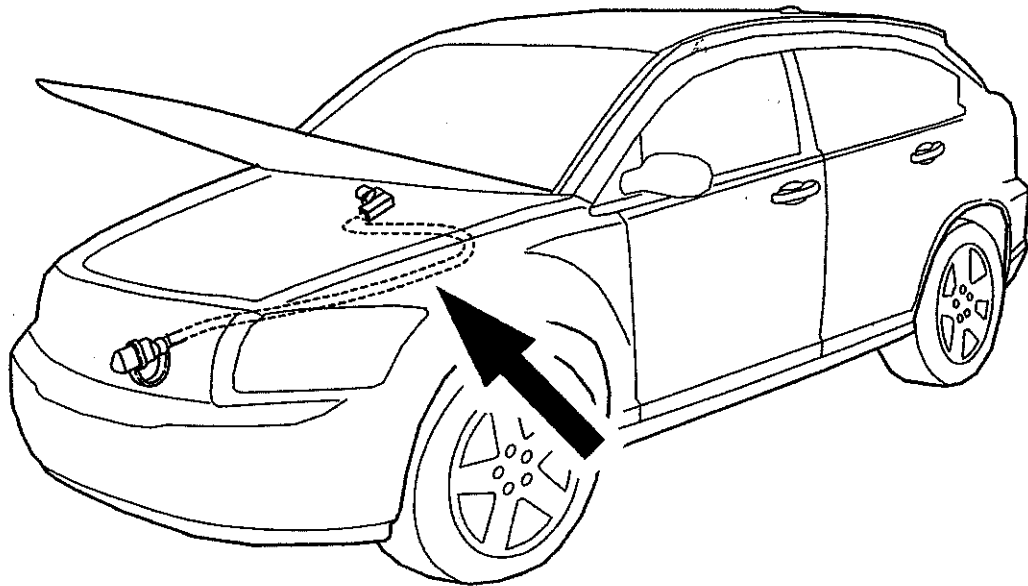

NOTE: Route cord away from any moving objects and tie wrap down.

REMARQUE: Conduisez le corde loin de tous les objets mobiles et attachez vers le bas

6

DESCRIPTION

The cartridge type block heater is mounted in a bore at the rear of the block under the coolant adapter. The block heater does not directly contact coolant. It heats the aluminum block.

The heater is powered by 110 Volt AC through a power cord and connector.

